



## KYAB05WL Pressure Transmitter for Automobile Air Conditioning System

### Description

The series of products are mainly used for automobile air conditioning system, measuring the automotive air conditioning refrigerant pipe pressure, and converted into a standard signal output.

### Applications

Automotive air conditioning systems dedicated

### Features:

- ◆ Small volume, stable performance, high measurement precision, ensure the air-conditioning system to achieve optimization of ECU control strategy
- ◆ Reliable quality, high performance price ratio, use of stainless steel diaphragm design and silicon strain sensing technology, strong overload capacity;
- ◆ No O-ring design, good media compatibility, 1g / year leakage standards;



### Dimension

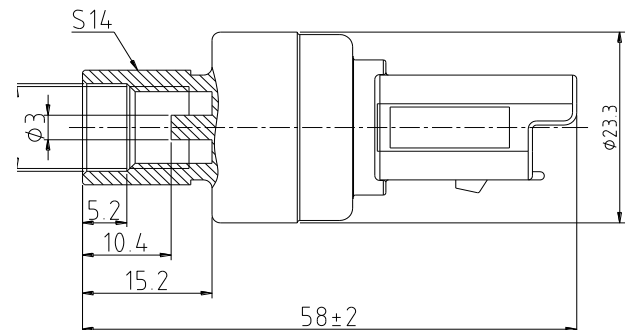

### Specifications:

Supply Voltage	4.5~5.5 VDC
Overtoltage protection	-14~16 VDC
Media	Clean non-corrosive air or liquid
Pressure Range (Gauge pressure)	0~3.4 MPa
Performance guarantee pressure	7 MPa
Burst Pressure	10.5 MPa
Output Voltage	0.4~4.48(@V <sub>cc</sub> =5.0VDC)
Error in normal temperature	±1.0 %FS
Error in working temperature range	±3.0 %FS
Operating Temperature	-30~120 °C
Storage Temperature	-40~125 °C
Operating Current	<7mA
Long-term Stability	±1.0%FS/year
Insulation Resistance	>110 MΩ/110V DC
Response time	2 ms
Mounting torque	≤15 N•m
Notes: (1)Output of pressure sensor: Proportional voltage output	



### Application Description:

The series of pressure transmitter is used to measure the refrigerant pipeline pressure of automotive air conditioning system, for ECU real-time monitoring, optimization and control strategy of the system, reduce the energy consumption at idle speed. It is widely used in all kinds of vehicle air conditioning system.

### Ordering Information:

Customized based on users requirements.

### Application picture:

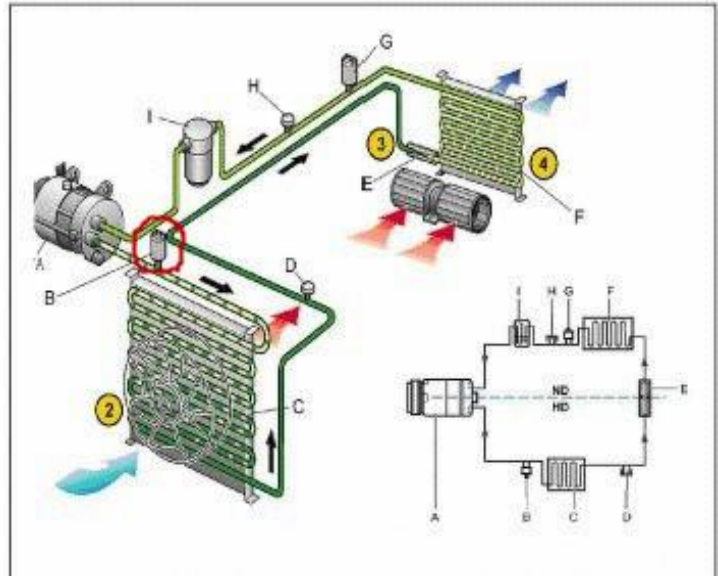

A- Air conditioning compressor; B- Pressure transmitter; C- Condenser; D- High pressure detection connector; E- The Guan orifice; F- Evaporator; H- Low pressure detection connector; I- Dry tank

**Gross Weight:** 25G

**Net Weight:** 20G

Xinhui KangYu Control Systems Engineering, Inc.

Guifeng Hightech Village, Ximen Rd., Xinhui District, Jiangmen City, Guangdong 529100, P.R. China

Tel: 86-750-6318857 Fax: 86-750-6318900 E-mail: [sale@chinakangyu.com](mailto:sale@chinakangyu.com) Website: [www.chinakangyu.com](http://www.chinakangyu.com)